

## Terminal Blocks, Heavy Duty

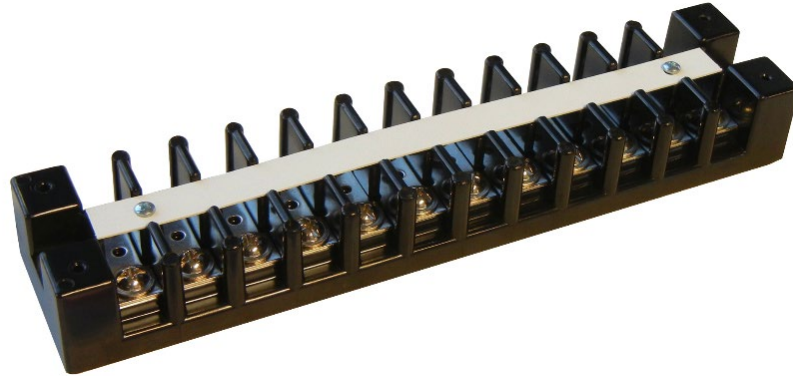

### 1. Scope

This standard covers the requirements for heavy-duty terminal blocks.

This standard applies to the following Seattle City Light (SCL) stock numbers:

Stock No.	Description
290308	8-pole terminal block
290309	8-pole terminal block marking strip
290310	12-pole terminal block
290311	12-pole terminal block marking strip

### 2. Application

Heavy-duty terminal blocks are used primarily for installations of short-circuiting bars and multiple-circuit jumpers in station control houses.

The manufacturer recommends a screw torque of 20 ft-lbs.

### 3. Industry Standards

Heavy-duty terminal blocks and marking strips shall meet the applicable requirements of the latest revision of the following industry standards:

**UL 1059**; Standard for Terminal Blocks

**UL 486A-486B**; Standard for Wire Connectors

**UL 94**; Test for Flammability of Plastic Materials for Parts in Devices and Appliances

*Muneer Shetab* *John Shipek*

*Andrew Strong*

#### 4. Requirements

Heavy-duty terminal blocks shall have the electrical ratings and attributes shown in Table 4.1, Table 4.2., and Figure 4.2.

**Table 4.1. Terminal Block Ratings and Attributes**

Voltage rating, maximum (Vdc and Vac)	600
Current rating, maximum (A)	
Unprepared wire, #10-22 AWG, copper	30
Crimp type ring, spade, or fork terminal	75
Base type	General purpose phenolic, 150° C maximum
Connectors	Brass or nickel plated
Screws	Brass or nickel plated, size 10-32
Block style	Removable connector with brass insert
Marking strip	Vinyl, white color
Screws	Zinc-plated steel

**Table 4.2. Terminal Block Dimensions**

Stock No.	Number of Poles	A (in)	B (in)
290308	8	6.38	5.72
290310	12	9.00	8.34

**Figure 4.2. Terminal Block Dimensions**

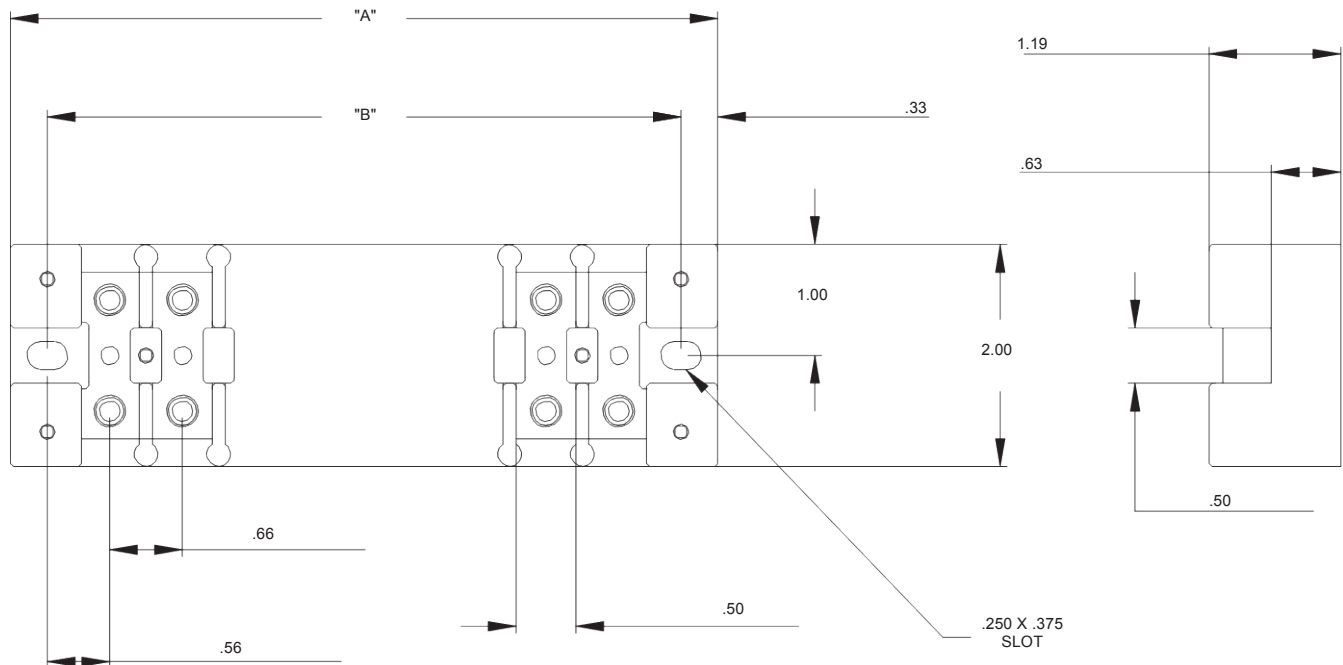

## 5. Packaging

Terminal blocks and marking strips shall be packaged to prevent damage during shipping, handling, and storage.

Each standard package shall be legibly marked with the following information:

- Manufacturer identification
- Product description
- SCL stock number
- Quantity

Each shipping container shall be legibly marked with the following information:

- SCL purchase order number
- 

## 6. Issuance

Stock Unit: EA

---

## 7. Approved Manufacturers

<b>Stock No.</b>	<b>Description</b>	<b>Marathon Special Products Part No.</b>
290308	8-pole terminal block	1608 DJ-SLB
290309	8-pole terminal block marking strip	MS1608-01
290310	12-pole terminal block	1612 DJ-SLB
290311	12-pole terminal block marking strip	MS16121-01

---

## 8. Sources

**[www.marathonsp.com](http://www.marathonsp.com)**

**Shetab, Muneer**; SCL Standards Engineer, originator, and subject matter expert for 6771.50

**Stock Catalog Page 20-9**; October 20, 2015