

Chain Links



1. Scope

This standard covers the material requirements for forged steel, hot-dip galvanized chain links.

This standard applies to the following Seattle City Light (SCL) stock numbers:

Stock No.	Ultimate Strength (lb)
696195	40,000
696200	60,000

2. Application

Chain links are used for connecting line hardware and insulators. They are commonly used in yoke plate assemblies to attach double strings of transmission class suspension insulators to supporting insulators and in pole top assemblies with static wire.

3. Industry Standards

Chain links shall meet the applicable requirement of the latest revision of the following industry standards:

ASTM A123; "Standard Specification for Zinc (Hot-Dip Galvanized) Coatings on Iron and Steel Products"

ASTM A576; "Standard Specification for Steel Bars, Carbon, Hot-Wrought, Special Quality"

Standards Coordinator
Muneer Shetab

Standards Supervisor
John Shipek

Unit Director
Andrew Strong

Muneer Shetab *John Shipek*

Andrew Strong

4. Requirements

Chain links shall be forged steel, hot dipped galvanized, and have the nominal attributes listed in Table 4.

Table 4. Chain Link Nominal Attributes

SCL Stock No.	A	B	C	D	Ultimate Strength (lb)
696195	3-1/4"	1"	5/8"	5/8"	40,000
696200	3-1/2"	1"	3/4"	3/4"	60,000

Figure 4. Chain Link Dimensions

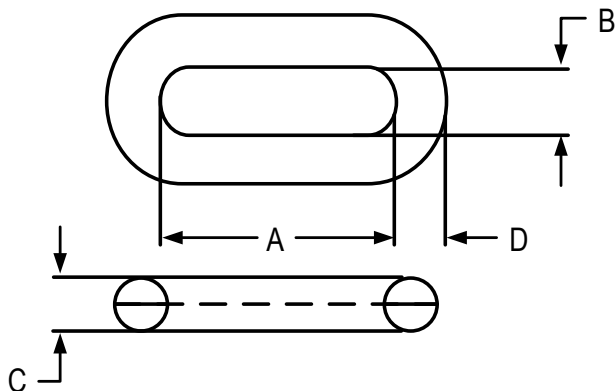

5. Packaging

Chain links shall be packaged to prevent damage during shipping, handling, and storage.

Each standard package shall be legibly marked with the following information:

- Manufacturer identification
- Product description
- SCL stock number
- Quantity contained

Each shipping container shall be legibly marked with the following information:

- Manufacturer's identification
- Country of origin
- Product description
- SCL purchase order number

6. Issuance

Stock Unit: EA

7. Approved Manufacturers

Stock No.	Hubbell Power Systems/ Anderson	Lindsey	MacLean Power Systems
696195	79272-2000	3403	CL5
696200	LK60	3405	CL6

8. Sources

Shetab, Muneer; SCL Standards Engineer, subject matter expert and originator of 6945.02 (muneer.shetab@seattle.gov)

SCL Material Standard 6970.15; "Yoke Plate Assembly, Deadend Strain"

SCL Construction standard 1621.20; "115 kV Angle Pole Top Assemblies"

Stock Catalog Page No. 69-62; January 27, 2012