

---

## Connectors, Service Post, Bronze

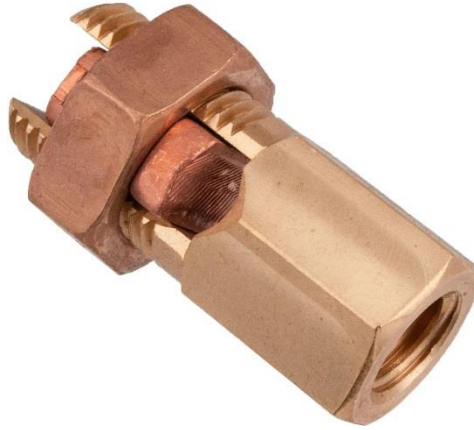

---

### 1. Scope

This standard covers the requirements for bronze service post connectors.

This standard applies to Seattle City Light (SCL) Stock No. 668872.

---

### 2. Application

Service post connectors are used to connect a single conductor to an external threaded stud.

Service post connectors are used for overhead and underground ground connections for steel structures, transformers, bus bars, and equipment.

Service post connectors are installed on the top and bottom, 3/8-16 threaded stud terminals of distribution system metal oxide arresters to facilitate the connection of primary and grounding conductors.

---

### 3. Industry Standards

Service post connectors shall meet the applicable requirements of the latest revision of the following industry standards:

**ANSI C119.4**, American National Standard for Electric Connectors— Connectors for Use between Aluminum-to-Aluminum and Aluminum-to-Copper Conductors Designed for Normal Operation at or Below 93°C and Copper-to-Copper Conductors Designed for Normal Operation at or Below 100°C

**UL 486A-486B**, Standard Name: Wire Connectors

**UL 467**, Standard for Safety Grounding and Bonding Equipment

#### 4. Requirements

Service post connectors shall have the following attributes:

- Made of high strength bronze or copper alloy
- Split bolt design with hex nut
- Hex body
- Female thread
- Physical design and dimensions in according Table 4 and Figure 4.
- Suitable for direct burial in earth or concrete

**Figure 4. Service Post Connector Design**

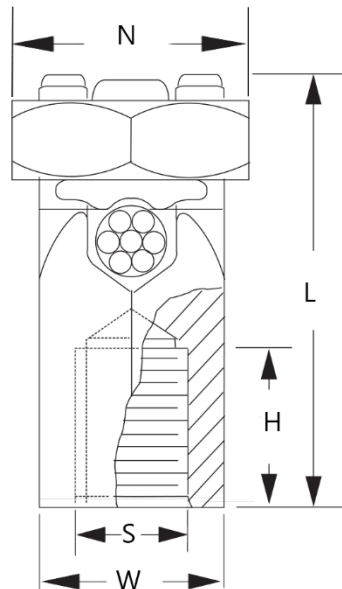

**Table 4. Service Post Connector Dimensions**

Conductor Range (AWG)	Connector Dimensions (in)				
	Stud Thread Size (S)	Stud Threaded depth (H)	Length(L)	Hex Body Width (W)	Hex Nut Width (N)
#6 - #2	3/8 - 16	3/8	1-5/8	11/16	7/8

#### 5. Marking

Service post connectors shall be legibly marked with the following:

- Manufacturer name or trademark
- Catalog number
- Conductor size

#### 6. Packaging

Service post connectors shall be packaged to prevent damage during shipping, handling, and storage.

Each standard package shall be legibly marked with the following information:

- Manufacturer identification
- Product catalog part number
- Product description
- Seattle City Light stock number
- Quantity

Each shipping container shall be legibly marked with the following information:

- Seattle City Light purchase order number
- 

## 7. Issuance

EA

---

## 8. Approved Manufacturers

<b>Manufacturer</b>	<b>Catalog No.</b>
Penn-Union	STS-4
Panduit	SPF1-2-C

---

## 9. Sources

**Stock Catalog Page 65-19**; January 08, 2010

**[www.panduit.com](http://www.panduit.com)**

**[www.penn-union.com](http://www.penn-union.com)**

**Wang, Quan**; SCL Standards Engineer, originator, and subject matter expert for 6689.03  
([quan.wang@seattle.gov](mailto:quan.wang@seattle.gov))