

VAULT, MANHOLE, HANDHOLE NUMBER IDENTIFICATION

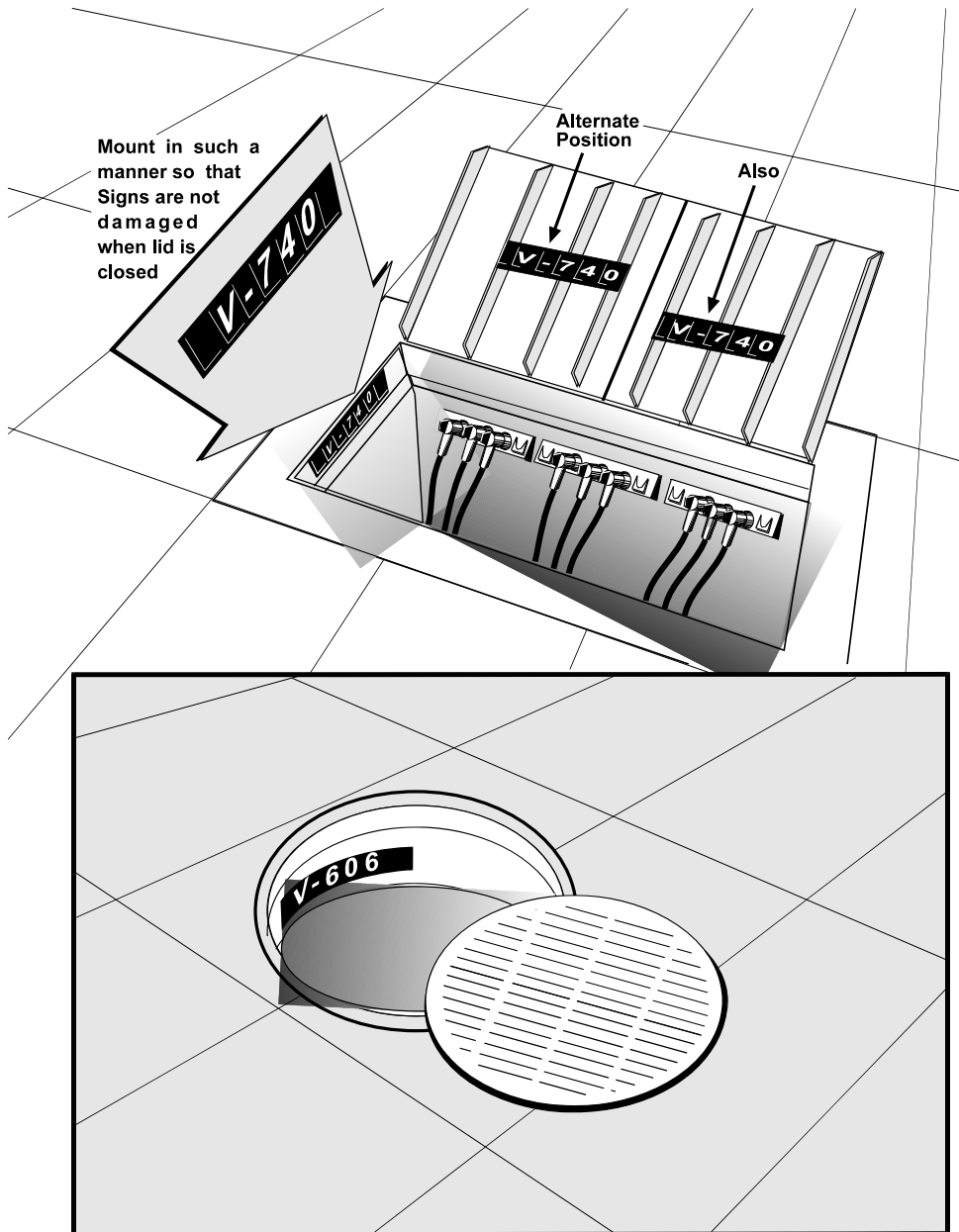

ORIGINATOR	STANDARDS COORDINATOR	STANDARDS SUPERVISOR	UNIT DIRECTOR
<i>Jim S. Horn</i>	<i>Charles L. Shaffer</i>	<i>John C. Skinner</i>	<i>Betty Robin</i>

CONSTRUCTION GUIDELINE

VAULT, AND HANDHOLE NUMBER IDENTIFICATION

All vaults, and handholes, 6' X 7' and larger shall have self-sticking letters and/or numbers applied for vault identification. These letters and/or numbers shall be 2-7/8" x 1-3/4", yellow on black background. On unfinished concrete, concrete block, or other rough surfaces, apply the letters and/or numbers on a plastic panel (Stock No. 766300). Attach the plastic panel with four anchor nail drive anchors (Stock No.780010E).

When the access to the vault or manhole is through the roof, fasten the plastic panel with the assigned letters and/or numbers on in the vault neck so it can be easily seen from above when the hatch or cover is opened or removed. On vaults or handholes with multiple access hatches, apply identification numbers to all entrances. See the illustrations on page 1 of this Construction Guideline.

On the outside of vault or switchroom doors, attach the self-stick vault identification letters and/or numbers. Attach the pressure sensitive vinyl sign, "DANGER HIGH VOLTAGE" (Stock No. 765182) with top of sign 6 feet from floor. Beneath this sign apply self-sticking sign, "ELECTRICAL VAULT, AUTHORIZED PERSONNEL ONLY" (Stock No. 765209).

Apply the designated self-stick letters and/or numbers on a minimum of three interior walls at 5 to 7 feet above the floor.

Stock Unit: PK
 25 per pack

MATERIAL LIST

ITEM	QUANTIT Y	STOCK NO.	DESCRIPTION
1	as req'd.	see Table 1	LETTERS & NUMERALS, Yellow ON Black, 2-7/8" x 1-3/4"
2	as req'd.	766310	PANEL, Blank, for above letters & numerals
3	as req'd.	780010E	NAIL, Anchor Drive, 1/4" x 1"
4	1 each	765182	SIGN, "DANGER HIGH VOLTAGE"
5	1 each	765209	SIGN, "ELECTRICAL VAULT, AUTHORIZED PERSONNEL ONLY"

TABLE 1
 YELLOW on BLACK, 2-7/8" X 1-3/4"

STOCK NO.	NUMBERS	STOCK NO.	LETTERS
766310	0	766328	A
766311	1	766332	B
766312	2	766329	C
766313	3	766335	D
766314	4	766320	H
766315	5	766334	K
766316	6	766321	M
766317	7	766322	N
766318	8	766323	P
766319	9	766324	S
		766333	T
STOCK NO.	CHARACTERS		
766331	FDR	766330	U
766327	- (dash)	766325	V
		766326	W