

**26/34.5 kV Vertical Switch, 1200 A, 3 Pole, Gang Operated,  
 for Wood Pole Mounting, 1200 A Cable Termination Industry Standards**

**Not for new construction. For maintenance of existing facilities only.**

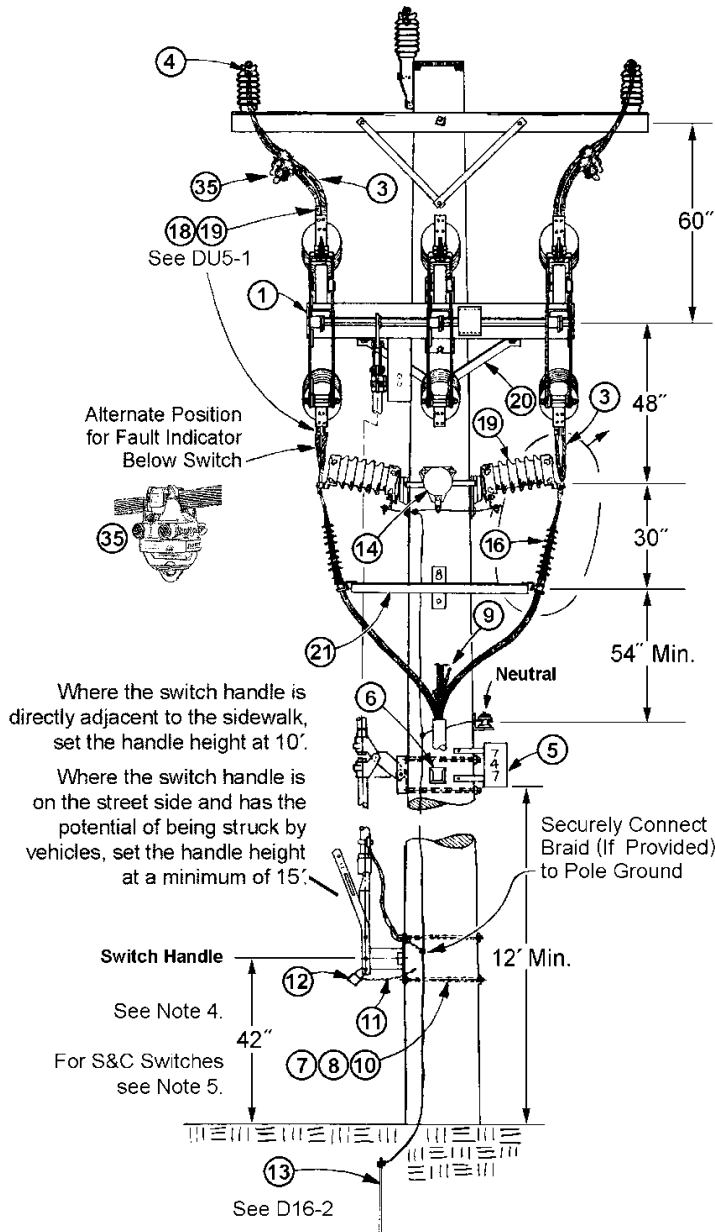

**Figure 1. Switch**

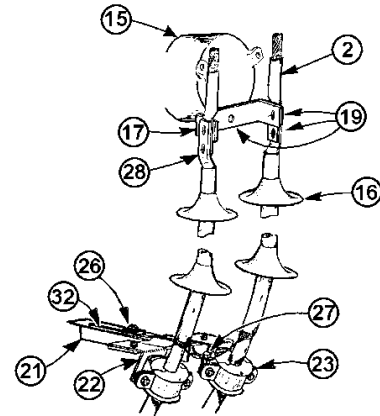

**Figure 2. Terminator Detail**

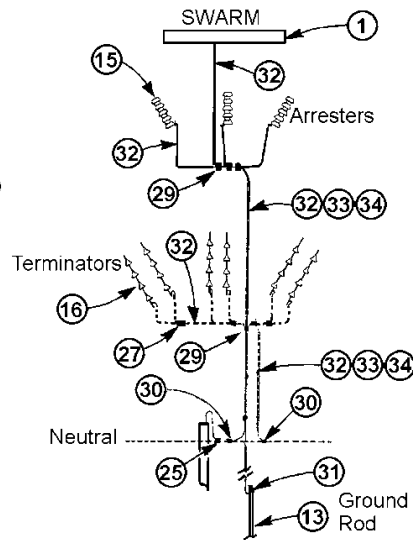

**Figure 3. Grounding Diagram**

Notes:

1. See erection drawing supplied with switch for switch and handle mounting details.
2. Rotate arresters on pole to provide clearance from switch handle.
3. Wire from top of switch to overhead conductors may be either 2 - 397.5 kcmil AAC or 1 - 954 kcmil AAC.
4. Where the switch handle will be directly adjacent to the sidewalk, set the handle height at 10'. Where the switch handle will be adjacent to the street and has the potential of being struck by vehicles, set the handle height at a minimum of 15'. Since a bucket truck will be required to operate the elevated switch handles, the design engineer shall note on the Work Order that this switch must always be operated with a bucket truck.
5. For S&C brand switches only: The distance from the centerline of the operating handle to the centerline of the switch base must not exceed 49' - 3-3/4". To comply with this limit on taller poles, the operating handle shall be mounted higher than 42" above ground, and the design engineer shall note on the Work Order that this switch must always be operated with a bucket truck. Generally speaking, this situation will occur with wood poles more than 65' in overall length.