

MATERIAL STANDARD

ACCESSORIES FOR IWCB ASSEMBLY

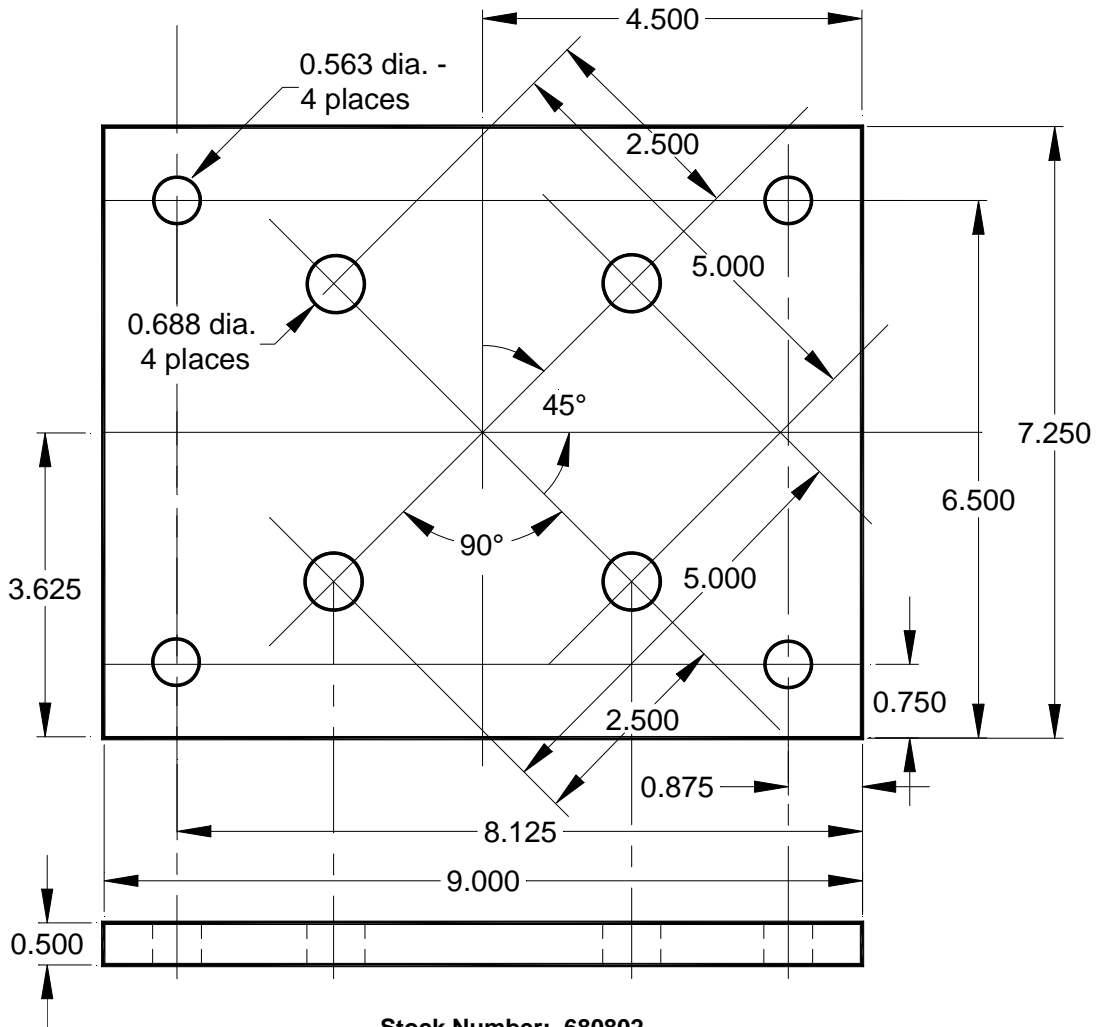

Stock Number: 680802

Measurements in drawings are in inches.

PLATE, MOUNTING, INSULATOR TO RAIL

NOTES FOR MOUNTING PLATE:

- (1) Dimension tolerance shall be $\pm 0.031"$, except hole diameters which shall be $+ 0.015$ and $- 0.000$.
- (2) Finished units shall be free of sharp edges, corners, and burrs.

References: DU-390

Material: Hot-rolled mild steel, ASTM A36.

Stock Number: 680802

ORIGINATOR	STANDARDS COORDINATOR	STANDARDS SUPERVISOR	UNIT DIRECTOR
<i>Jim S. Horn</i>	<i>Charles L. Shaffer</i>	<i>Al Piernberg</i>	<i>Harold Juy</i>

MATERIAL STANDARD

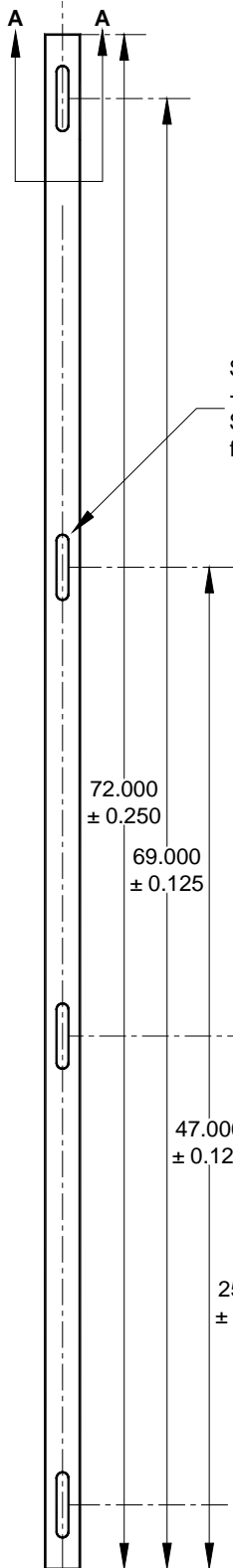

Slotted Holes
- 4 places.
See Detail A-A
for slot dimension.

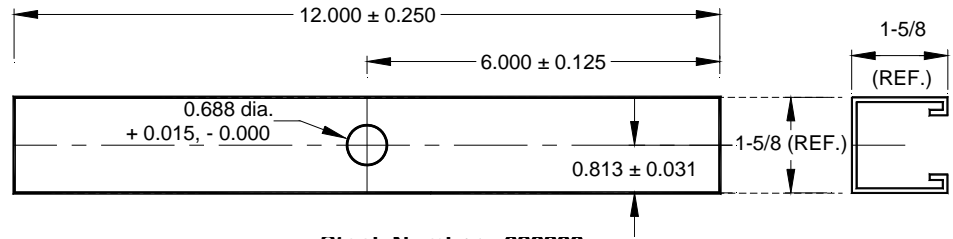

Stock Number: **680800**

Measurements in drawings are in inches.
TIE, ANCHOR TO RAIL

Material:

Anchor and Rail Tie, 12-gage steel Channel, 1-5/8" x 1-5/8"
unpunched, pre-galvanized finish.

Unitstrut #P1000 (PG); Eristrut #A12 (PG); Powerstrut #PS200
(PG) or equivalent.

Stock Unit: EA

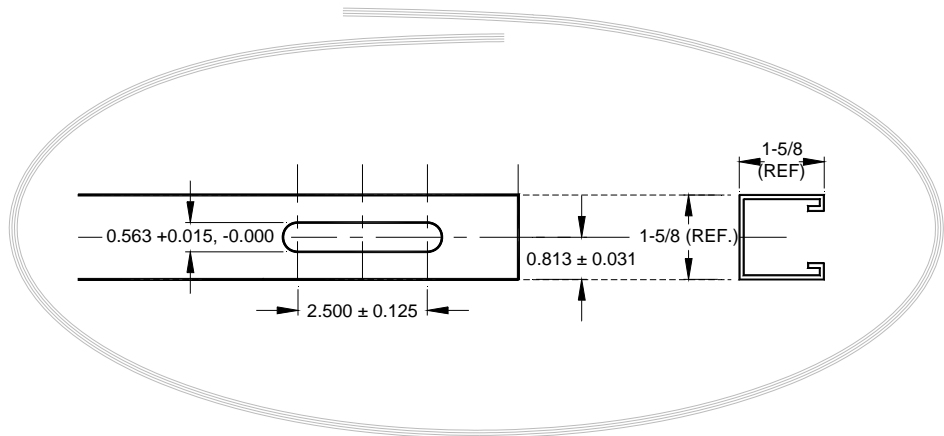

Detail A-A:

**RAIL
Slot and Cross-Section**

RAIL, TIE TO MOUNTING PLATE

Stock Number: **680801**